

Where Do You Live?

Read the clues to find where each person lives in the apartment building. As you discover where each person lives, write the person's name in the apartment.

- At Rosebud Terrace, there are 8 apartments. The names of the tenants are Bill, Madeline, Warrick, Pamela, Quincy, Salma, Todd, and Kendra.
 - Salma lives on the second floor.
 - Quincy lives directly above Warrick.
 - Bill lives next to Pamela.
 - Madeline lives to the left of Warrick and to the right of Kendra.
 - Todd lives to the left of Quincy.
 - Pamela lives right above Todd.

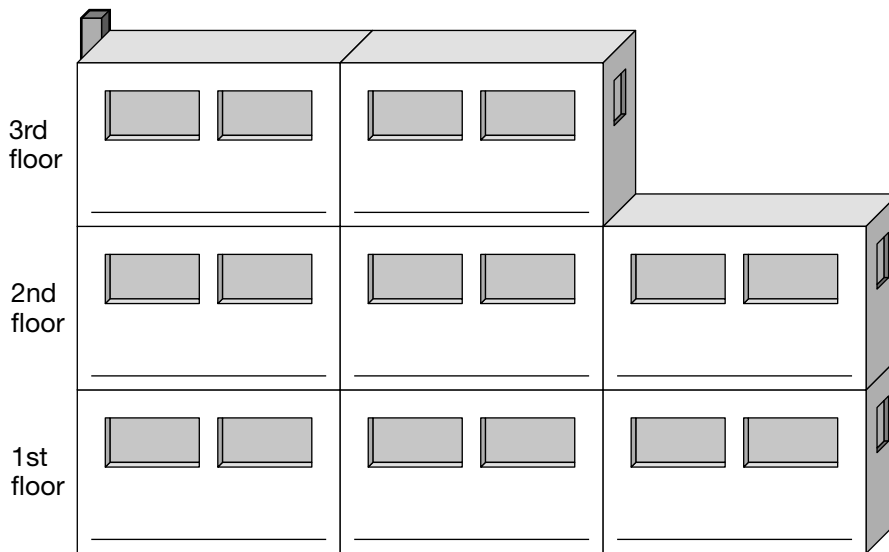

- Explain how you found each person's place in the apartment building.
